

# *Products*

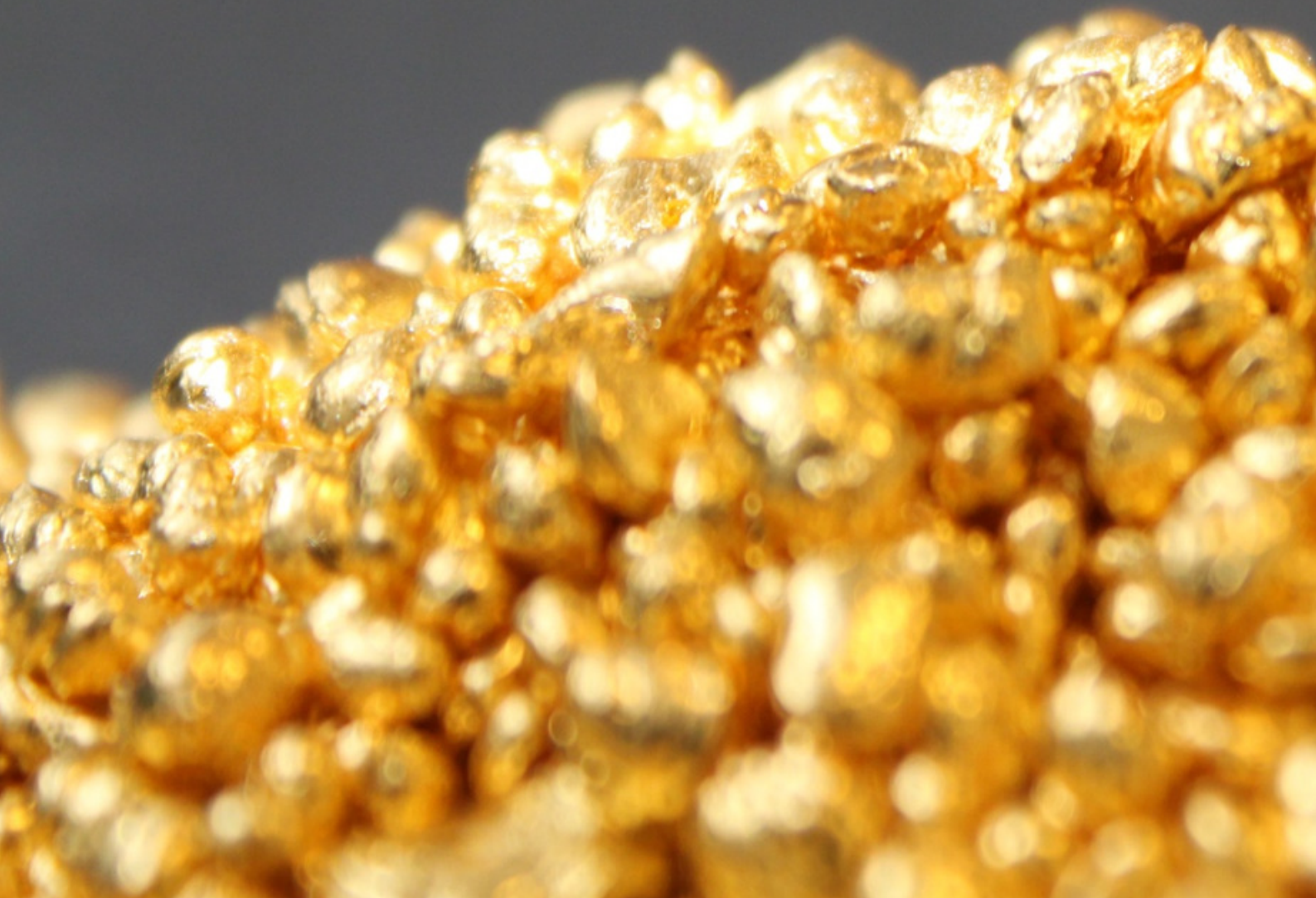

**goldrecycling.com**



In this brochure we show our standard range of products which we offer. We can of course provide more products upon request.

On all products is the price on request.

Delivery time varies from three to six weeks with a few exceptions.

You can of course submit your precious metal scrap to us and avail yourself to a metal account. After refining (takes about three weeks) you will get grams credited to your metal account. When you order next time, you can count of the programs on your new order and therefore pay less. When using metal account counted grams against gram. You will pay only for exceeding grams precious metal and manufacturing cost and freight. Of course you can also sell the metal on your weight account to daily price and get your credit balance paid in cash.

For more information or to place an order please contact us;

**031 72 72 206, [info@goldrecycling.com](mailto:info@goldrecycling.com)**



## CRUCIBLES

**made of platinum/iridium 97/3, platinum/gold 95/5 or FKS-platinum/gold 95/5**

| Inner Ø | Height | Base thickness | Capacity | Weight | Code |
|---------|--------|----------------|----------|--------|------|
| mm      | mm     | mm             | ml       | g      |      |
| A       | C      | S              |          |        |      |
| 20      | 23     | 0,19           | 5        | 3,7    | 20   |
| 23      | 26     | 0,17           | 7        | 5,2    | 21   |
| 26      | 30     | 0,20           | 10       | 7,7    | 22   |
| 28      | 32     | 0,29           | 15       | 12     | 23   |
| 30      | 35     | 0,36           | 20       | 17     | 24   |
| 35      | 37     | 0,36           | 25       | 21     | 25   |
| 35      | 40     | 0,36           | 30       | 25     | 26   |
| 40      | 45     | 0,36           | 40       | 30     | 27   |
| 45      | 50     | 0,36           | 50       | 38     | 28   |
| 50      | 55     | 0,40           | 75       | 52     | 29   |
| 55      | 60     | 0,40           | 100      | 65     | 30   |

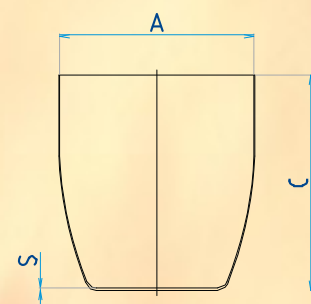

### Crucible with reinforced rim

**made of platinum/iridium 97/3, platinum/gold 95/5 or FKS-platinum/gold 95/5**

| Inner Ø | Height | Base thickness | Capacity | Weight | Code |
|---------|--------|----------------|----------|--------|------|
| mm      | mm     | mm             | ml       | g      |      |
| A       | C      | S              |          |        |      |
| 20      | 23     | 0,19           | 5        | 4,5    | 20V  |
| 23      | 26     | 0,17           | 7        | 6      | 21V  |
| 26      | 30     | 0,20           | 10       | 9      | 22V  |
| 28      | 32     | 0,29           | 15       | 14     | 23V  |
| 30      | 35     | 0,36           | 20       | 19     | 24V  |
| 35      | 37     | 0,36           | 25       | 23     | 25V  |
| 35      | 40     | 0,36           | 30       | 27     | 26V  |
| 40      | 45     | 0,36           | 40       | 33     | 27V  |
| 45      | 50     | 0,36           | 50       | 41     | 28V  |
| 50      | 55     | 0,40           | 75       | 55     | 29V  |
| 55      | 60     | 0,40           | 100      | 69     | 30V  |

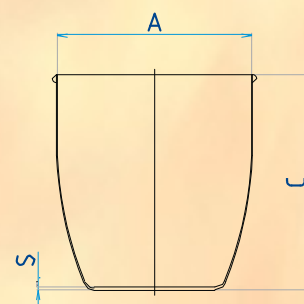

LIDS – fit crucibles and dishes both with and without reinforced rims

**made of platinum/iridium 97/3, platinum/gold 95/5 or FKS-platinum/gold 95/5**

| Inner Ø | Height | Material thickness | Weight | code |
|---------|--------|--------------------|--------|------|
| mm      | mm     | mm                 | g      |      |
| A       | C      | S                  |        |      |
| 20      | 2,8    | 0,13               | 2,0    | 20DE |
| 23      | 2,8    | 0,13               | 2,3    | 21DE |
| 26      | 3,1    | 0,13               | 2,6    | 22DE |
| 28      | 3,1    | 0,13               | 3,2    | 23DE |
| 30      | 3,6    | 0,13               | 3,6    | 24DE |
| 35      | 4,1    | 0,13               | 4,7    | 26DE |
| 40      | 4,5    | 0,13               | 5,8    | 27DE |
| 45      | 4,5    | 0,13               | 6,6    | 28DE |
| 50      | 5,1    | 0,13               | 8,8    | 29DE |
| 55      | 5,1    | 0,13               | 10,5   | 30DE |
| 60      | 5,4    | 0,13               | 12,1   | 42DE |
| 70      | 5,4    | 0,13               | 15,0   | 43DE |
| 80      | 6,0    | 0,13               | 19,9   | 44DE |
| 90      | 6,0    | 0,13               | 24,0   | 45DE |
| 100     | 6,0    | 0,13               | 27,0   | 46DE |
| 110     | 6,0    | 0,13               | 31,0   | 47DE |
| 120     | 6,0    | 0,13               | 37,0   | 48DE |
| 130     | 6,0    | 0,13               | 42,0   | 49DE |

## DISHES WITH FLAT BASE

**made of platinum/iridium 97/3, platinum/gold 95/5 or FKS-platinum/gold 95/5**

| Inner Ø | Height | Base thickness | Capacity | Weight | code       |               |
|---------|--------|----------------|----------|--------|------------|---------------|
| mm      | mm     | mm             | ml       | g      | with spout | without spout |
| A       | C      | S              |          |        |            |               |
| 40      | 20     | 0,16           | 20       | 8      | 40         | 40X           |
| 50      | 25     | 0,18           | 35       | 14     | 41         | 41X           |
| 60      | 30     | 0,18           | 50       | 22     | 42         | 42X           |
| 70      | 35     | 0,20           | 90       | 32     | 43         | 43X           |
| 80      | 40     | 0,22           | 150      | 48     | 44         | 44X           |
| 90      | 45     | 0,24           | 200      | 65     | 45         | 45X           |
| 100     | 50     | 0,27           | 250      | 90     | 46         | 46X           |
| 110     | 55     | 0,30           | 325      | 125    | 47         | 47X           |
| 120     | 60     | 0,31           | 400      | 150    | 48         | 48X           |
| 130     | 65     | 0,31           | 500      | 175    | 49         | 49X           |

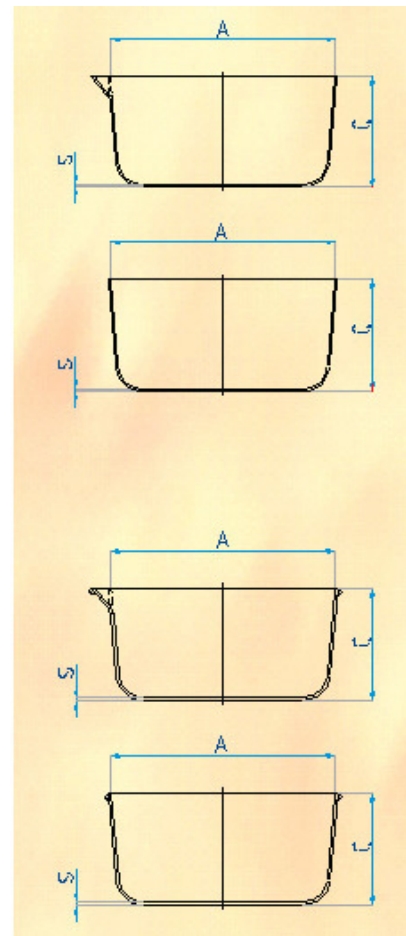

## DISHES WITH FLAT BASE and reinforced rim

**made of platinum/iridium 97/3, platinum/gold 95/5 or FKS-platinum/gold 95/5**

| Inner Ø | Height | Base thickness | Capacity | Weight | code       |               |
|---------|--------|----------------|----------|--------|------------|---------------|
| mm      | mm     | mm             | ml       | g      | with spout | without spout |
| A       | C      | S              |          |        |            |               |
| 40      | 20     | 0,16           | 20       | 10     | 40V        | 40VX          |
| 50      | 25     | 0,18           | 35       | 16     | 41V        | 41VX          |
| 60      | 30     | 0,18           | 50       | 26     | 42V        | 42VX          |
| 70      | 35     | 0,20           | 90       | 36     | 43V        | 43VX          |
| 80      | 40     | 0,22           | 150      | 53     | 44V        | 44VX          |
| 90      | 45     | 0,24           | 200      | 71     | 45V        | 45VX          |
| 100     | 50     | 0,27           | 250      | 96     | 46V        | 46VX          |
| 110     | 55     | 0,30           | 325      | 132    | 47V        | 47VX          |
| 120     | 60     | 0,31           | 400      | 157    | 48V        | 48VX          |
| 130     | 65     | 0,31           | 500      | 183    | 49V        | 49VX          |

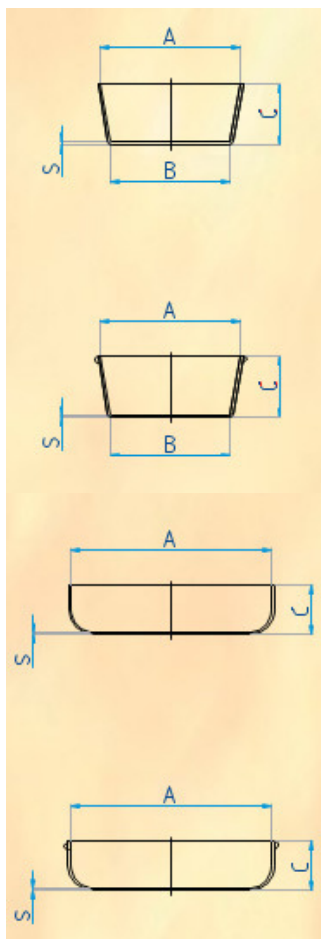

## DISHES FOR ASHING FLOUR

**made of gold/platinum 90/10 or gold/palladium 80/20**

| Upper inner Ø | Base inner Ø | Height | Base thickness | Weight Au/Pt | Weight Au/Pd | code |
|---------------|--------------|--------|----------------|--------------|--------------|------|
| mm            | mm           | mm     | mm             | g            | g            |      |
| A             | B            | C      | S              |              |              |      |
| 40            | 36           | 16     | 0,15           | 7,0          | 6,2          | 60   |
| 45            | 36           | 18     | 0,13           | 7,0          | 6,2          | 61   |
| 50            | 45           | 20     | 0,15           | 10,0         | 8,8          | 62   |

## DISHES FOR ASHING FLOUR with reinforced rim

**made of gold/platinum 90/10 or gold/palladium 80/20**

| Upper inner Ø | Base inner Ø | Height | Base thickness | Weight Au/Pt | Weight Au/Pd | code |
|---------------|--------------|--------|----------------|--------------|--------------|------|
| mm            | mm           | mm     | mm             | g            | g            |      |
| A             | B            | C      | S              |              |              |      |
| 40            | 36           | 16     | 0,15           | 9,0          | 9            | 60V  |
| 45            | 36           | 18     | 0,13           | 9,0          | 8            | 61V  |
| 50            | 45           | 20     | 0,15           | 12,0         | 10,6         | 62V  |

## WINE DISHES FLAT BASE

**made of platinum/iridium 97/3, platinum/gold 95/5 or FKS-platinum/gold 95/5**

| Inner Ø | Height | Base thickness | Capacity | Weight | code |
|---------|--------|----------------|----------|--------|------|
| mm      | mm     | mm             | ml       | g      |      |
| A       | C      | S              |          |        |      |
| 85      | 20     | 0,14           | 75       | 22,0   | 65   |



### CRUCIBLE TONGS MADE OF CHROMIUM-NICKEL STEEL

Shoes or tips made of platinum/iridium 97/3, platinum/gold 95/5 or pure platinum

| Overall length<br>mm<br>A | approx. weight<br>per pair<br>g | Design             | code  |
|---------------------------|---------------------------------|--------------------|-------|
| 200                       | 4-5                             | with Pt shoes      | S 200 |
| 250                       | 4-5                             | with Pt shoes      | S 250 |
| 300                       | 4-5                             | with Pt shoes      | S 300 |
| 400                       | 7-8                             | with Pt shoes      | S 400 |
| 500                       | 7-8                             | with Pt shoes      | S 500 |
| 600                       | 9-10                            | with Pt shoes      | S 600 |
| 200                       | 10-12                           | with solid Pt tips | M 200 |
| 250                       | 10-12                           | with solid Pt tips | M 250 |
| 300                       | 10-12                           | with solid Pt tips | M 300 |
| 400                       | 24-25                           | with solid Pt tips | M 400 |
| 500                       | 30-35                           | with solid Pt tips | M 500 |
| 600                       | 30-35                           | with solid Pt tips | M 600 |

### TWEEZERS MADE OF CHROMIUM NICKEL STEEL

Shoes or tips made of platinum/iridium 97/3, platinum/gold 95/5 or pure platinum

| Overall length<br>mm<br>A | approx. weight<br>per pair<br>g | Design             | code  |
|---------------------------|---------------------------------|--------------------|-------|
| 145                       | 2                               | with Pt shoes      | S 145 |
| 145                       | 4                               | with solid Pt tips | M 145 |

### SPATULAS

For reasons related to stability spatulas are fabricated from the alloy platinum/iridium 90/10 and are available in a variety of lengths and shapes.

Please let us know dimensions you need for your applications.

**Legend** to the spatula drawing: **A1** spatula length, **A2** handle length, **B1** spatula width, **B2** handle width

### INOCULATION LOOPS

Eyelets made of platinum/iridium 90/10 for microbiology and medical applications are available in various diameters and lengths. Please let us know the dimensions you need.

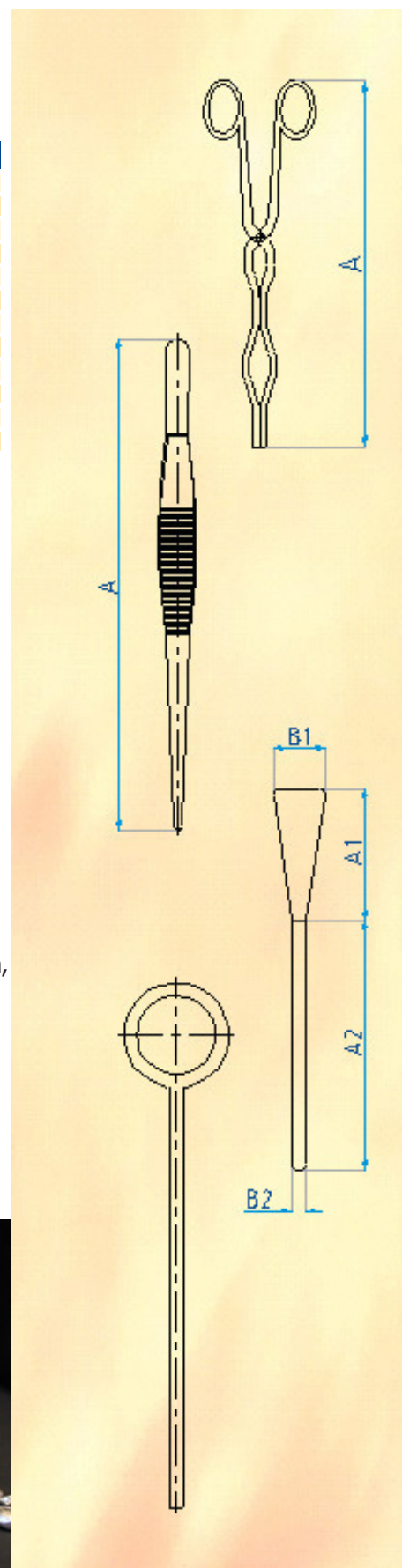

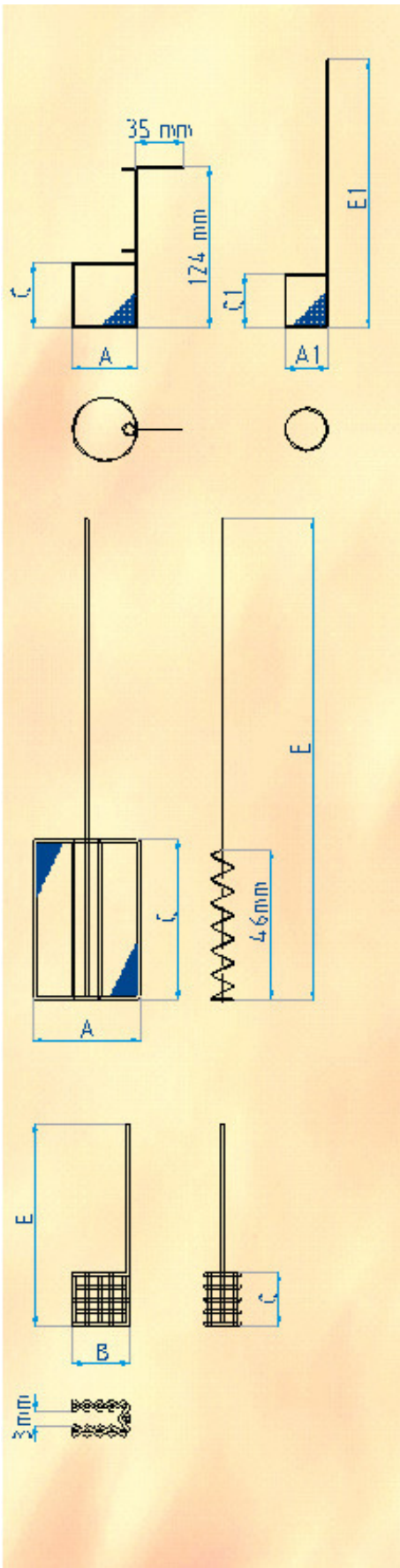

### FISCHER ELECTRODE

made of platinum/iridium 90/10

| M/cm <sup>2</sup> | Net    |      | Cylinder |          |    |     | Overall length mm | Weight g | Design | code |
|-------------------|--------|------|----------|----------|----|-----|-------------------|----------|--------|------|
|                   | mm     | Ø mm | outer mm | inner mm | mm | mm  |                   |          |        |      |
|                   | Ø Wire | A    | C        | A1       | C1 | E1  |                   |          |        |      |
| 225               | 0,12   | 38   | 50       | 33       | 40 | 200 | 33                | light    | FI 1   |      |
| 100               | 0,25   | 38   | 50       | 33       | 40 | 200 | 41                | heavy    | FI 2   |      |

### WINKLER ELECTRODE

made of platinum/iridium 90/10

| M/cm <sup>2</sup> | Net    |      | Cylinder |     | Overall length mm | Weight g | Design | code |
|-------------------|--------|------|----------|-----|-------------------|----------|--------|------|
|                   | mm     | Ø mm | mm       | mm  |                   |          |        |      |
|                   | Ø Wire | A    | C        | E   |                   |          |        |      |
| 225               | 0,12   | 35   | 50       | 150 | 15                | light    | WI 1   |      |
| 100               | 0,25   | 35   | 50       | 150 | 21                | heavy    | WI 2   |      |
|                   | 1,1    |      | 46       | 150 | 5,5               | spiral   | WI 1B  |      |

### WOELBLING ELECTRODE

made of platinum/iridium 90/10

| M/cm <sup>2</sup> | Net    |      | Cylinder |     | Overall length mm | Weight g | Design | code |
|-------------------|--------|------|----------|-----|-------------------|----------|--------|------|
|                   | mm     | Ø mm | mm       | mm  |                   |          |        |      |
|                   | Ø Wire | A    | C        | E   |                   |          |        |      |
| 100               | 0,25   | 18   | 40       | 150 | 15                | solid    | WB 1   |      |
| 100               | 0,25   | 18   | 40       | 150 | 16                | hollow   | WB 2   |      |
| 100               | 0,25   | 30   | 40       | 150 | 20                | solid    | WB 3   |      |
| 100               | 0,25   | 30   | 40       | 150 | 22                | hollow   | WB 4   |      |
| 100               | 0,25   | 45   | 50       | 150 | 35                | solid    | WB 5   |      |
| 100               | 0,25   | 45   | 50       | 150 | 37                | hollow   | WB 6   |      |

### SCHOENIGER ELECTRODE

made of pure platinum

| M/cm <sup>2</sup> | Net |        | Electrode width mm | Electrode height mm | Overall length mm | Weight g | code |
|-------------------|-----|--------|--------------------|---------------------|-------------------|----------|------|
|                   | mm  | Ø Wire |                    |                     |                   |          |      |
|                   | B   | C      | E                  |                     |                   |          |      |
| 16                | 10  | 10     | 40                 | 3                   | ELS               |          |      |



**BOAT WITH HANDLE**

of pure platinum, platinum/iridium 97/3 or platinum/gold 95/5

| Boat length | Handle length | Width | Height | Weight | code |
|-------------|---------------|-------|--------|--------|------|
| mm          | mm            | mm    | mm     | g      |      |
| A1          | A2            | B     | C      |        |      |
| 15          | 6             | 4     | 4      | 1      | SHI  |

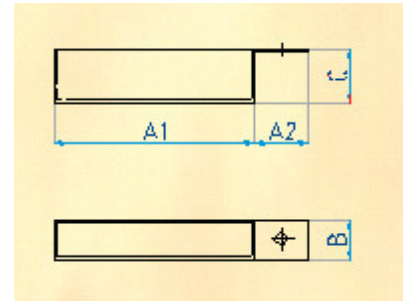

**MINI-CRUCIBLES**

of pure platinum, platinum/iridium 97/3 or platinum/gold 95/5

| Upper inner Ø  | Base inner Ø | Height | Base thickness | Weight | code |
|----------------|--------------|--------|----------------|--------|------|
| mm             | mm           | mm     | mm             | g      |      |
| A              | B            | C      | S              |        |      |
| Mini-crucibles |              |        |                |        |      |
| 12,5           | 12           | 15     | 0,15           | 1,5    | 64   |
| Lids           |              |        |                |        |      |
| 12             | -            | 2      | 0,13           | 0,6    | 64DE |

**CASTING DISHES, ROUND DESIGN**

made of platinum/gold 95/5 or FKS-platinum/gold 95/5

| Upper inner Ø | Base inner Ø | Height | Overall Ø | Material thickness | Weight | code |
|---------------|--------------|--------|-----------|--------------------|--------|------|
| mm            | mm           | mm     | mm        | mm                 | g      |      |
| A             | B            | C      | F         | S                  |        |      |
| 31            | 29           | 3,8    | 41        | 0,8                | 23     | AB1R |
| 34            | 32           | 3,8    | 41        | 0,8                | 23     | AB2R |
| 36            | 34           | 3,8    | 51        | 0,8                | 35     | AB3R |
| 41            | 39           | 3,8    | 51        | 0,8                | 35     | AB4R |

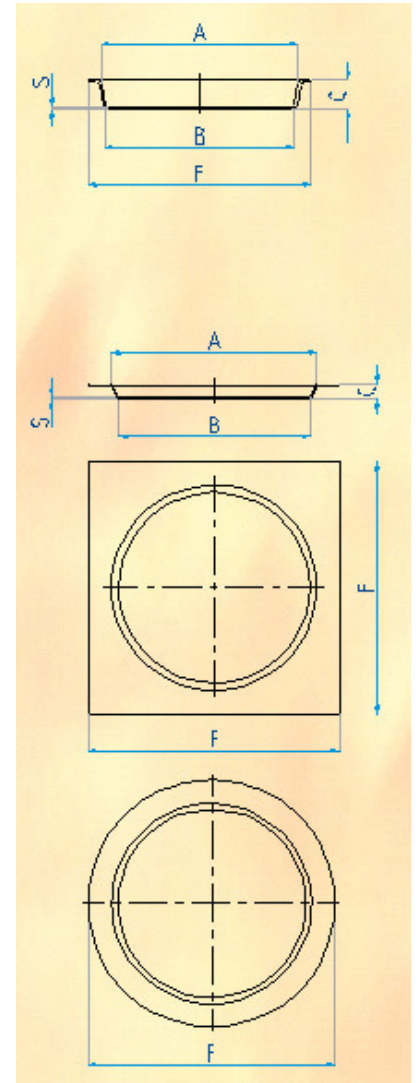

**CASTING DISHES, SQUARE DESIGN**

made of platinum/gold 95/5 or FKS-platinum/gold 95/5

| Upper inner Ø | Base inner Ø | Height | Edge length | Material thickness | Weight | code |
|---------------|--------------|--------|-------------|--------------------|--------|------|
| mm            | mm           | mm     | mm          | mm                 | g      |      |
| A             | B            | C      | F           | S                  |        |      |
| 31            | 29           | 3,8    | 41          | 0,8                | 30     | AB1  |
| 34            | 32           | 3,8    | 41          | 0,8                | 30     | AB2  |
| 36            | 34           | 3,8    | 51          | 0,8                | 46     | AB3  |
| 41            | 39           | 3,8    | 51          | 0,8                | 46     | AB4  |

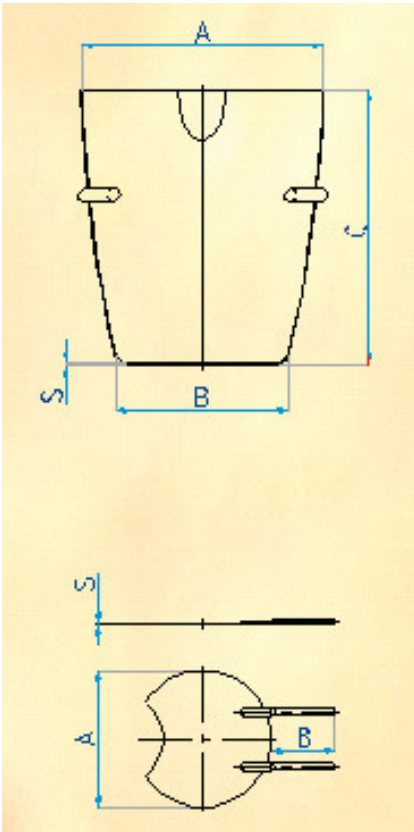
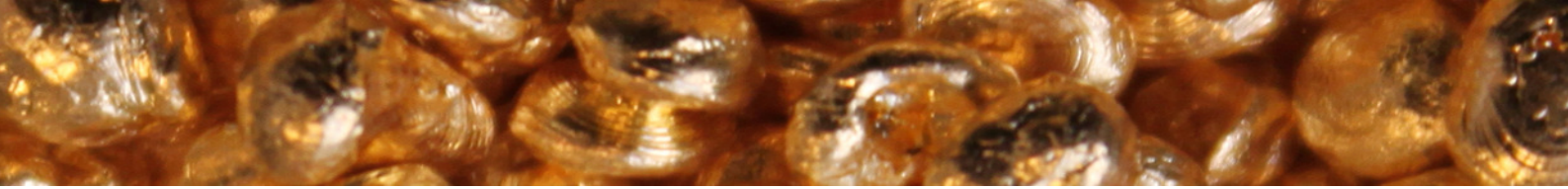

**CRUCIBLES FOR FUSION EQUIPMENT BY SCHOEPS, VAA, USG, AAG**  
made of platinum/gold 95/5 or FKS-platinum/gold 95/5

| Upper inner Ø<br>mm | Base inner Ø<br>mm | Height<br>mm | Base thickness<br>mm | Weight<br>g | Design         | code  |
|---------------------|--------------------|--------------|----------------------|-------------|----------------|-------|
| A                   | B                  | C            | S                    |             |                |       |
| 34                  | 20                 | 38           | 0,35                 | 33          |                | 82    |
| 34                  | 20                 | 38           | 0,50                 | 41          |                | 80    |
| 34                  | 20                 | 38           | 0,50                 | 43          | reinforced rim | 80BRV |
| 34                  | 20                 | 38           | 0,60                 | 44          |                | 81    |

**LIDS FOR FUSION EQUIPMENT BY SCHOEPS, VAA, USG, AAG**  
made of platinum/gold 95/5 or FKS-platinum/gold 95/5

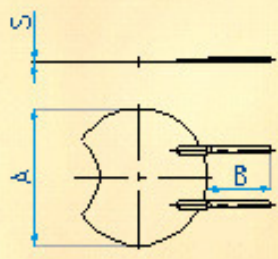

| Lid Ø<br>mm | Pin length<br>mm | Material thickness<br>mm | Weight<br>g | code<br>g |
|-------------|------------------|--------------------------|-------------|-----------|
| A           | B                | S                        |             |           |
| 45          | 21               | 0,3                      | 14          | 88        |

**CRUCIBLE FOR CLAISSE FLUXERS**  
made of platinum/gold 95/5 or FKS-platinum/gold 95/5

| Upper inner Ø<br>mm | Base inner Ø<br>mm | Height<br>mm | Overall Ø<br>mm | Base thickness<br>mm | Weight<br>g | Design      | code |
|---------------------|--------------------|--------------|-----------------|----------------------|-------------|-------------|------|
| A                   | B                  | C            | F               | S                    |             |             |      |
| 37                  | 20                 | 35           | 44              | 0,45                 | 35          | flat base   | 72   |
| 39,5                | 20                 | 32           | 43              | 0,35                 | 30          | flat base   | 71   |
| 39,5                | 20                 | 32           | 43              | 0,35                 | 30          | convex base | 70   |

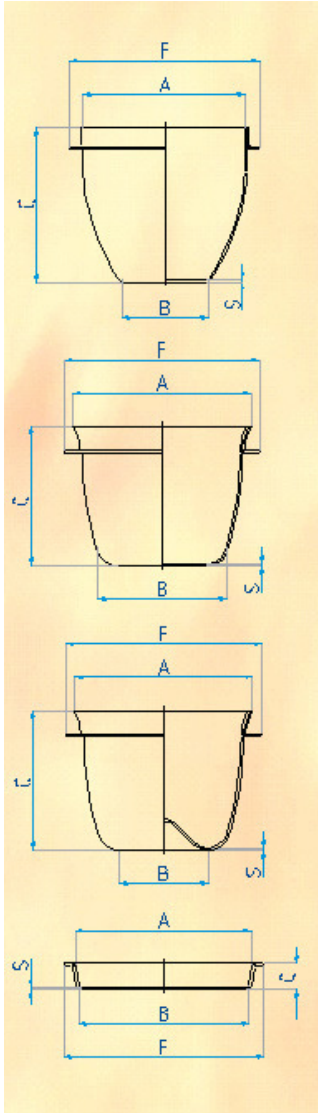

**CASTING DISH FOR CLAISSE FLUXERS**  
made of platinum/gold 95/5 or FKS-platinum/gold 95/5

| Upper inner Ø<br>mm | Base inner Ø<br>mm | Height<br>mm | Overall Ø<br>mm | Material thickness<br>mm | Weight<br>g | code |
|---------------------|--------------------|--------------|-----------------|--------------------------|-------------|------|
| A                   | B                  | C            | F               | S                        |             |      |
| 26                  | 25                 | 6            | 45              | 0,60                     | 25          | 78   |
| 33                  | 32                 | 6            | 45              | 0,60                     | 25          | 79   |
| 36                  | 35                 | 6            | 45              | 0,60                     | 25          | 77   |
| 40                  | 38                 | 6            | 45              | 1,00                     | 41          | 76   |
| 40                  | 38                 | 6            | 45              | 0,6                      | 24          | 75   |

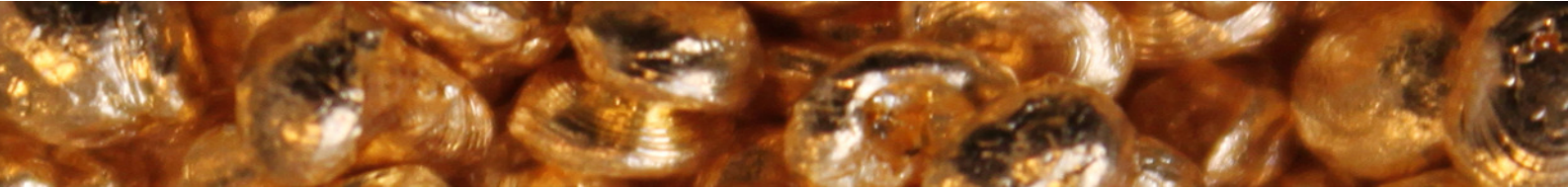

### CRUCIBLE FOR PERL-X FUSION EQUIPMENT

made of platinum/gold 95/5 or FKS-platinum/gold 95/5

| Upper inner Ø<br>mm | Base inner Ø<br>mm | Height<br>mm | Ø incl. flange<br>mm | Base thickness<br>mm | Weight<br>g | Design      | code |
|---------------------|--------------------|--------------|----------------------|----------------------|-------------|-------------|------|
| A                   | B                  | C            | F                    | S                    |             |             |      |
| 40                  | 40                 | 40           | 50                   | 1,0                  | 95          | cylindrical | 90   |
| 40                  | 40                 | 40           | 49                   | 0,8                  | 85          | cylindrical | 91   |
| 40                  | 40                 | 40           | 48                   | 0,8                  | 80          | cylindrical | 91A  |
| 40                  | 40                 | 40           | 50                   | 0,8                  | 78          | cylindrical | 91B  |
| 40                  | 40                 | 40           | 50                   | 0,8                  | 85          | cylindrical | 92   |
| 40                  | 22                 | 40           | 49                   | 0,9                  | 80          |             | 93   |
| 40                  | 22                 | 40           | 49                   | 1,1                  | 100         |             | 94   |
| 40                  | 24                 | 40           | 48                   | 0,8                  | 75          |             | 95   |

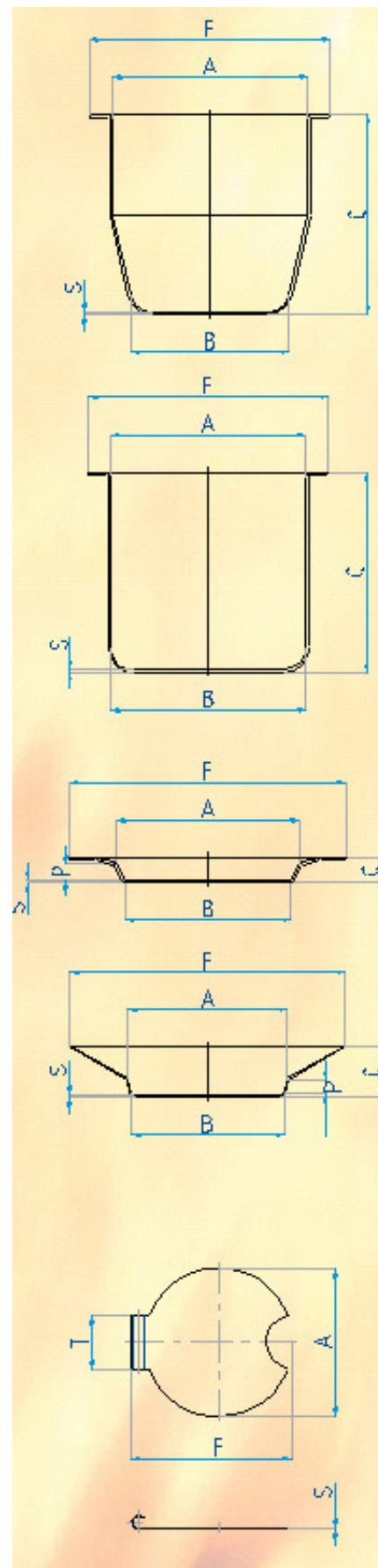

### CASTING DISHES FOR PERL-X FUSION EQUIPMENT

made of platinum/gold 95/5 or FKS-platinum/gold 95/5

| Upper inner Ø<br>mm | Base inner Ø<br>mm | Height<br>mm | Ø incl. flange<br>mm | Base thickness<br>mm | Weight<br>g | code |
|---------------------|--------------------|--------------|----------------------|----------------------|-------------|------|
| A                   | B                  | C            | F                    | S                    |             |      |
| low profile         |                    |              |                      |                      |             |      |
| 32                  | 30                 | 5            | 55                   | 1,0                  | 50          | 104  |
| 36                  | 35                 | 2,7          | 55                   | 0,7                  | 40          | 105  |
| 37                  | 34,5               | 4,9          | 55                   | 0,9                  | 45          | 106  |
| 37                  | 34,5               | 5            | 55                   | 1,0                  | 55          | 107  |
| 37                  | 35                 | 5            | 55                   | 1,0                  | 55          | 108  |
| high profile        |                    |              |                      |                      |             |      |
| 34                  | 32                 | 10           | 65                   | 1,0                  | 55          | 109  |
| 32                  | 30,5               | 10           | 65                   | 1,0                  | 55          | 110  |
| 40                  | 38,5               | 10           | 65                   | 1,0                  | 60          | 111  |
| 40,5                | 39,5               | 11,5         | 65                   | 1,0                  | 65          | 112  |
| 37                  | 35                 | 10           | 63,5                 | 1,0                  | 50          | 113  |
| 41                  | 39,5               | 10           | 60                   | 1,0                  | 65          | 114  |
| 35,5                | 33,5               | 10,5         | 65                   | 0,7                  | 53          | 115  |

### LIDS FOR PERL-X FUSION EQUIPMENT

made of platinum/gold 95/5 or FKS-platinum/gold 95/5

| Upper inner Ø<br>mm | Overall length<br>mm | Material thickness<br>mm | Weight<br>g | Hinge width<br>mm | Ögussa code |
|---------------------|----------------------|--------------------------|-------------|-------------------|-------------|
| A                   | F                    | S                        |             | T                 |             |
| 55                  | 68                   | 0,5                      | 30          | 18                | 100A        |
| 55                  | 68                   | 0,5                      | 27          | 10                | 100         |
| 55                  | 60                   | 0,5                      | 27          | 19,2              | 101         |
| 55                  | 68                   | 0,5                      | 27          | 10                | 102         |

### CRUCIBLE FOR LECO FUSION EQUIPMENT

made of platinum/gold 95/5 or FKS-platinum/gold 95/5

| Upper inner Ø<br>mm | Base inner Ø<br>mm | Height<br>mm | Ø incl. flange<br>mm | Base thickness<br>mm | Weight<br>g | code |
|---------------------|--------------------|--------------|----------------------|----------------------|-------------|------|
| A                   | B                  | C            | F                    | S                    |             |      |
| 37                  | 20                 | 35,0         | 44                   | 0,45                 | 35          | 120  |
| 37                  | 20                 | 40,0         | 44                   | 0,50                 | 40          | 121  |

### CRUCIBLE FOR LINN FUSION EQUIPMENT

made of platinum/gold 95/5 or FKS-platinum/gold 95/5

| Upper outer Ø<br>mm | Base outer Ø<br>mm | Height<br>mm | Base thickness<br>mm | Weight<br>g | code |
|---------------------|--------------------|--------------|----------------------|-------------|------|
| A                   | B                  | C            | S                    |             |      |
| 41                  | 20                 | 49,5         | 0,40                 | 35          | 125  |
| 34,6                | 19,6               | 48,0         | 0,55                 | 42          | 126  |
| 35                  | 20                 | 48,0         | 0,40                 | 35          | 127  |

### DOUBLE-CONE CRUCIBLES

made of platinum/gold 95/5 or FKS-platinum/gold 95/5

| Upper inner Ø<br>mm | Ø upper cone<br>mm | Base inner Ø<br>mm | Height<br>mm | Base thickness<br>mm | Weight<br>g | code |
|---------------------|--------------------|--------------------|--------------|----------------------|-------------|------|
| A                   | B1                 | B                  | C            | S                    |             |      |
| 38                  | 34                 | 29                 | 39,3         | 0,80                 | 53          | 67A  |
| 40                  | 36                 | 34                 | 40           | 0,80                 | 64          | 67B  |
| 45                  | 41                 | 36                 | 43,3         | 0,80                 | 75          | 67   |

### CRUCIBLES WITH THREE PINS

made of platinum/gold 95/5 or FKS-platinum/gold 95/5

| Upper inner Ø<br>mm | Base inner Ø<br>mm | Height<br>mm | Base thickness<br>mm | Weight<br>g | code |
|---------------------|--------------------|--------------|----------------------|-------------|------|
| A                   | B                  | C            | S                    |             |      |
| 44                  | 32                 | 30           | 1,00                 | 60          | 66   |
| 40                  | 30                 | 30           | 0,45                 | 33          | 68   |
| 40                  | 30                 | 30           | 0,30                 | 20          | 69   |

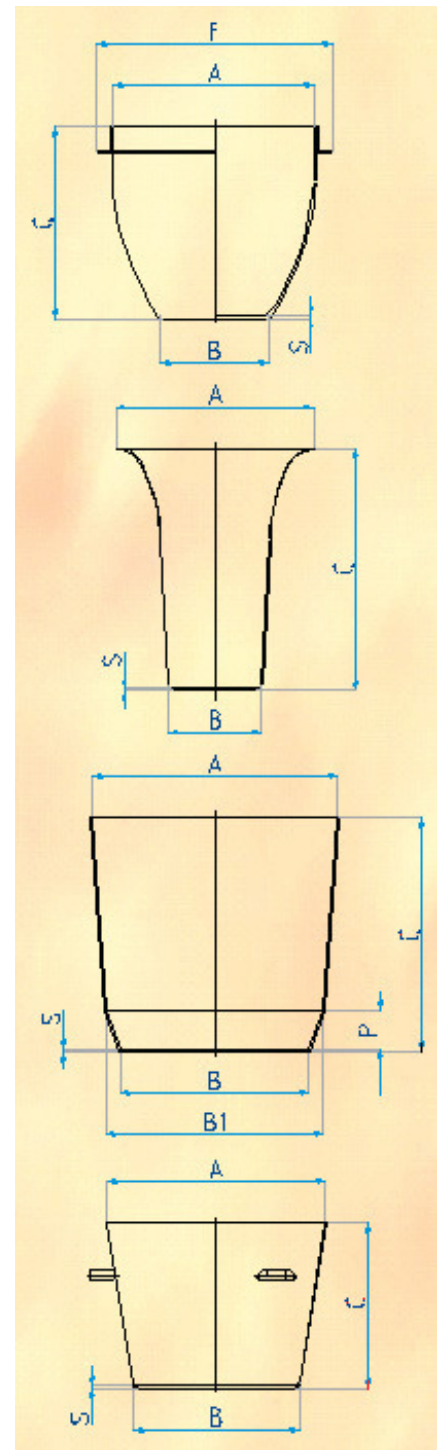

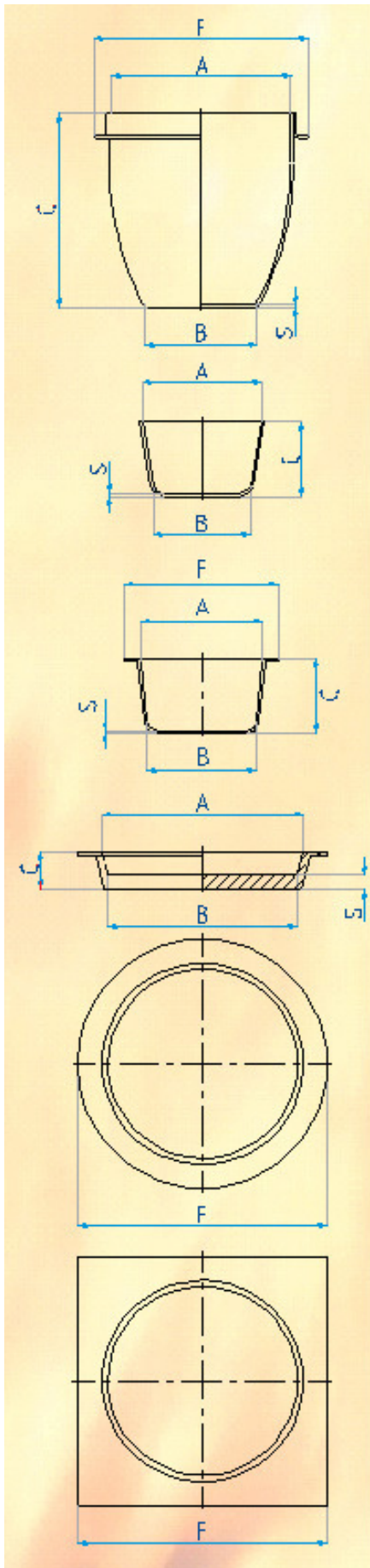
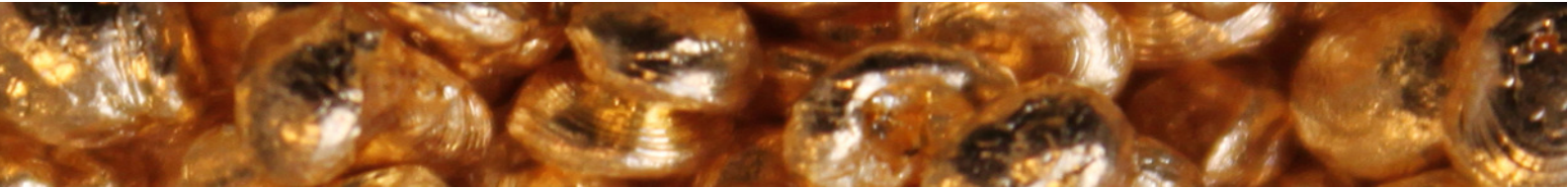

### CRUCIBLES FOR HERZOG FUSION EQUIPMENT

made of platinum/gold 95/5 or FKS-platinum/gold 95/5

| Upper inner Ø<br>mm | Base inner Ø<br>mm | Height<br>mm | Ø incl. flange<br>mm | Base thickness<br>mm | Weight<br>g | code |
|---------------------|--------------------|--------------|----------------------|----------------------|-------------|------|
| A                   | B                  | C            | F                    | S                    |             |      |
| 36                  | 22,3               | 38,5         | 44                   | 0,60                 | 52          | 132  |
| 50                  | 38,5               | 30           | -                    | 1,00                 | 90          | 130  |
| 50                  | 38,5               | 30           | 62                   | 1,00                 | 110         | 131  |

### CASTING DISHES FOR HERZOG FUSION EQUIPMENT

made of platinum/gold 95/5 or FKS platinum/gold 95/5

| Upper inner Ø<br>mm | Base inner Ø<br>mm | Height<br>mm | Ø incl. flange<br>mm | Base thickness<br>mm | Weight<br>g | Design | code |
|---------------------|--------------------|--------------|----------------------|----------------------|-------------|--------|------|
| A                   | B                  | C            | F                    | S                    |             |        |      |
| 34                  | 32                 | 6            | 44                   | 2,50                 | 65          | round  | 788  |
| 40                  | 38                 | 7,5          | 50                   | 3,00                 | 113         | square | 682  |

### CRUCIBLES FOR OXIFLUX FUSION SYSTEMS

made of platinum/gold 95/5 or FKS-platinum/gold 95/5

| Upper inner Ø<br>mm | Base inner Ø<br>mm | Height<br>mm | Base thickness<br>mm | Weight<br>g | Design            | code |
|---------------------|--------------------|--------------|----------------------|-------------|-------------------|------|
| A                   | B                  | C            | S                    |             |                   |      |
| 36                  | 18                 | 40           | 0,35                 | 30          | with pins         | 160  |
| 36                  | 18                 | 40           | 0,35                 | 37          | with support ring | 161  |

### CASTING DISHES FOR OXIFLUX FUSION SYSTEMS

made of platinum/gold 95/5 or FKS-platinum/gold 95/5

| Upper inner Ø<br>mm | Base inner Ø<br>mm | Height<br>mm | Ø incl. flange<br>mm | Base thickness<br>mm | Weight<br>g | code |
|---------------------|--------------------|--------------|----------------------|----------------------|-------------|------|
| A                   | B                  | C            | F                    | S                    |             |      |
| 32                  | 31                 | 4,8          | 43                   | 0,80                 | 34          | 162  |

### CRUCIBLES FOR PHOENIX FUSION EQUIPMENT

made of platinum/gold 95/5 or FKS-platinum/gold 95/5

| Upper inner Ø<br>mm | Base inner Ø<br>mm | Height<br>mm | Base thickness<br>mm | Weight<br>g | code |
|---------------------|--------------------|--------------|----------------------|-------------|------|
| A                   | B                  | C            | S                    |             |      |
| 36                  | 22                 | 36           | 0,45                 | 40          | 151  |

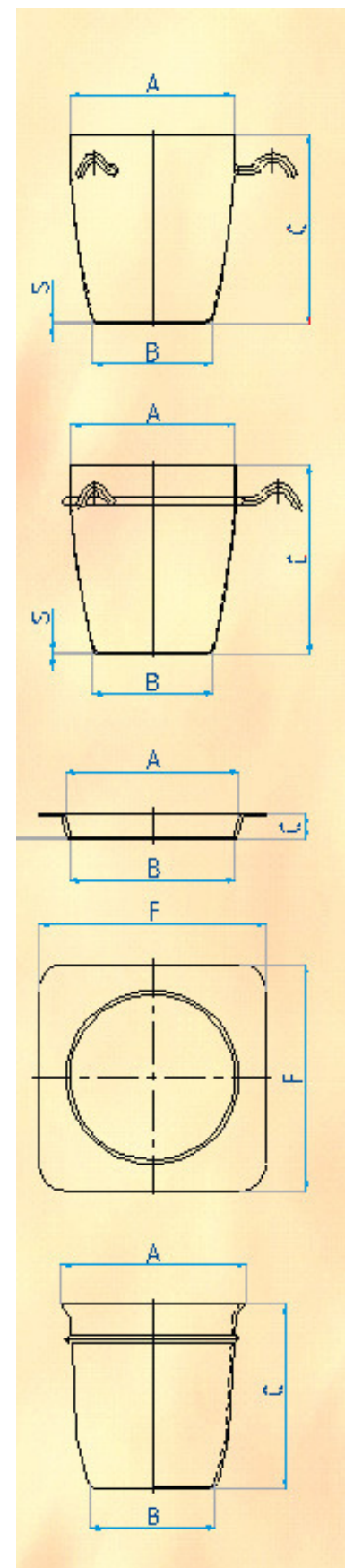



Contact rivets 6x2x4x3

AG 999

AG 97/CU 3

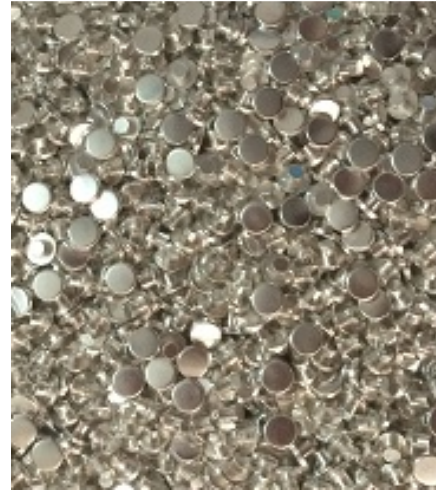
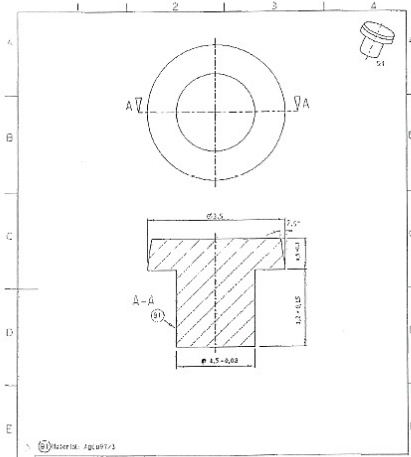

Silverniträt  $\text{AgNO}_3$  63,6%



Fine platinum wire on a bobbin  
Thickness 0.15-0.60

Wire and sheets in fine metal.  
Many different dimensions.

Fine gold and fine silver  
granules with up to  
99.99% metal content.



**031 72 72 206, [info@goldrecycling.com](mailto:info@goldrecycling.com)**



**Svensk Dentalåtervinning AB**

**Göteborgsvägen 89**

**431 30 Mölndal**

**031-72 72 206**

**[info@goldrecycling.com](mailto:info@goldrecycling.com)**

**[www.goldrecycling.com](http://www.goldrecycling.com)**